

HOW TO IDENTIFY AN ORIGINAL BILSTEIN PRODUCT

STEP BY STEP

STEP 1



Find the Security Label:

When you receive your next delivery, look for the new BILSTEIN security label. It is located on the article label on the packaging.

STEP 2



QR Code Scan or CheckIfReal app*

A quick scan of the QR code with your smartphone will take you directly to the BILSTEIN verification page. Through this process, you can check the authenticity of the product.

STEP 3



Grant Access

Confirm the end-user license agreement and privacy policy, and allow access to your camera and, if necessary, your location.

STEP 4

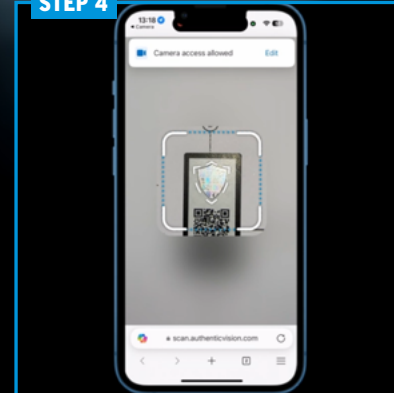

Scan the Security Label

During the scanning process, align the provided markers over the BILSTEIN security label.

STEP 5

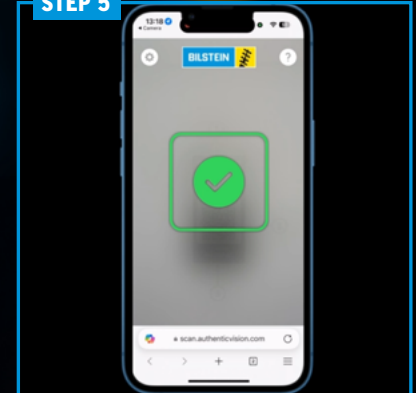

Verification

After a successful scan, a green check mark will appear. This means the product is an authentic BILSTEIN product. If a red check mark appears, your product could not be verified as authentic. Please contact your authorized dealer for assistance.

Alternatively, you can download the CheckIfReal app from the iOS App Store or Google Play Store and install it. **Install CheckIfReal.**

BILSTEIN

